



**250**

PARKING SPACES

**7 min**

DRIVE TO LUXEMBOURG'S CITY CENTRE

**Wi-fi**

FREE INTERNET ACCESS

**Relax**

INDOOR SWIMMING POOL, SAUNA AND FITNESS CENTRE

**10 min**

BY CAR FROM LUX AIRPORT AND KIRCHBERG DISTRICT

**Shuttle**

COMPLIMENTARY UPON REQUEST AND SUBJECT TO AVAILABILITY



**DOUBLETREE**  
by Hilton™  
LUXEMBOURG

## DoubleTree by Hilton Luxembourg Your Home Abroad

Whether you are relocating to Luxembourg, working on a project or just need temporary accommodations, the DoubleTree by Hilton Luxembourg will welcome you with a warm cookie and our surrounding woodlands will transport you out of the LUX airport and Kirchberg District. Easily accessible by car or public transportation, the hotel offers all of the facilities you need and more to ensure you feel at home.

- Enjoy modern European cuisines and signature Luxembourg dishes at our restaurant and bar The Green.
- Unwind in our heated indoor swimming pool or sauna.
- Keep fit and rid yourself of any tensions in our gym.





**Deluxe Suite with Kitchenette**  
area 63 m<sup>2</sup>

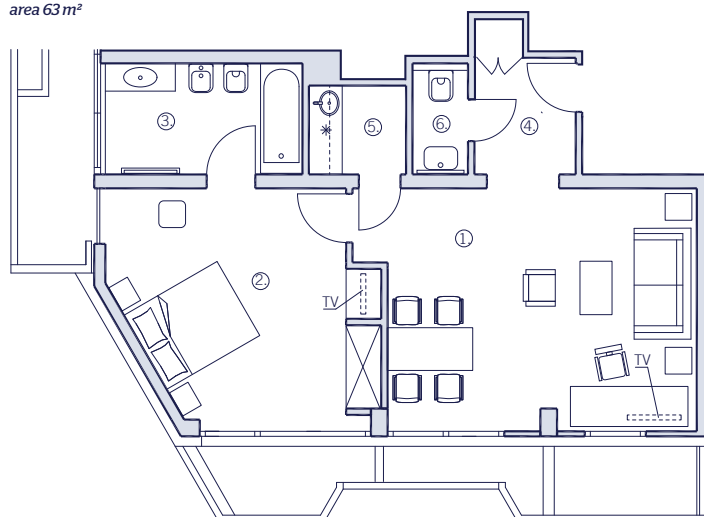

No. in plan	Room Type	No. in plan	Room Type
1	Living room	4	Entrance
2	Bedroom	5	Kitchenette
3	Bathroom	6	WC

**Junior Suite**  
area 47 m<sup>2</sup>

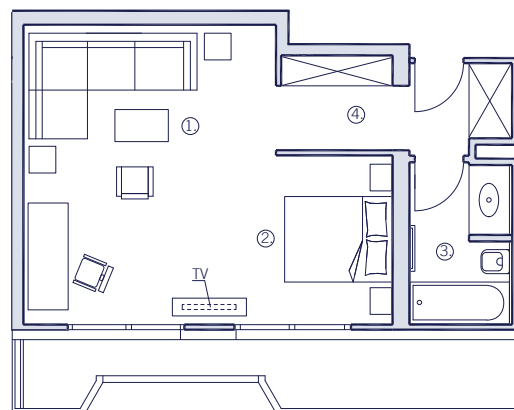

#### Room Types

Room Type	Square Meters	Count
Standard Queen	27	105
Superior King	29-35	132
Deluxe King	34-42	51
Junior Suite	44-47	23
Deluxe Suite / Family Suite	51	10
Deluxe Suite with Kitchenette	63	24
<b>Total</b>		<b>345</b>

## Discover The Additional Advantages Secured For Our Long Stay Guests

### Leisure

- **Family members** to be accommodated **free of charge** in the same room
- **50% discount** on our Best Available Rate for an **Extra room** over the weekend
- **Luxcards** offered to help you discover the city and benefit from discounts on all main attractions
- **Running maps**

### Mobility

- Use of our **Shuttle** within a 10 km radius (upon request and subject to availability)
- **Preferential monthly parking fee** available. Please ask our Sales team

### F&B

- Special rate for the **Dish of the day** (room service available at no extra cost)
- **20% discount** on all **Bar beverages**
- Residential style **Kitchen** with microwave-grill, refrigerator, kettle etc.
- Weekly **Fruit basket**
- Daily bottle of **Mineral water** placed in your bedroom
- Grab and go **Coffee**

### Other Benefits

- Pre-arrival consultation, local area expertise
- **30% off** our **Laundry service**
- **Express dry cleaning** service at no extra cost
- Support with **Proof of residency**
- Complimentary daily **Newspaper** as per guest choice
- Complimentary **2 hour use** of our **Meeting rooms** available once a month, subject to availability
- **Business services:** faxing, copying, printing, and packaging free of charge
- Complimentary **Local calls**

### For Long Stay Enquiries

Tel +352 43 78 80 49 | reservation@doubletree-luxembourg.com